

Vision Satellite PF Entryway Foam Sanitizer

MODEL # 976724

OVERVIEW

The Vision Satellite Pump Fed Entryway Foam Sanitizer is an automated foam applicator for projecting sanitizing chemicals on to floors of 3' wide employee walk doors to prevent cross contamination. When activated, this system is fed with RTU chemical solution from a central chemical feed system. Rich, clinging foam is created by injecting compressed air into the solution to greatly increase volume and coverage ability. Foam is then projected through the discharge hose and Spreader™ nozzle. Vision Satellite units are activated by compressed air from the Vision Controller and operated by compressed air local to the satellite - no electrical connection is required at the entryway location. The Vision Controller features highly flexible programmable settings with multiple options to precisely manage the foam sanitizing of up to six zones of multiple doorways with independent settings for each zone.

Key Features

- Applies a layer of rich, clinging foam to entryway floors to prevent cross-contamination
- Designed for 3' wide employee walk doors
- Fed with ready to use chemical solution from a central chemical pumping system
- The unique Spreader™ nozzle lays a foam pattern 3' across and 4' wide to ensure all foot traffic and cart wheels are fully exposed to the sanitizer
- Automatic activation and shutoff for use in moderate to high traffic areas
- Activated by compressed air from the Vision Satellite Controller - no electrical connection required at the entryway door.
- Each Vision Satellite Foamer requires a separate direct connection to compressed air for foamer operation
- Adjustable foam consistency (wet/dry)
- Chemical resistant wetted components ensure durability and years of reliable service with minimal maintenance
- Used in conjunction with a **6-Zone PLC Vision Entryway Satellite Controller (#976710)**:
 - Allows variable settings for holidays, weekly or seasonal changes hours of operation and peak traffic demands
 - Controls up to 6 satellite zones simultaneously, with up to 10 Vision Pump Fed Satellites per zone.
 - Each zone is programmed independently
- Available for larger doors (#976725, 976726)
- See [Catalog 6](#) for other entryway configurations

Includes

- Stainless steel mounting plate
- Air activated air solenoid
- Air activated stainless steel solution solenoid
- Machined polypropylene foamer body
- Foam enhancer
- 10' discharge hose
- Entryway Spreader™ nozzle

OPTIONS

Regulate the Operation of Multiple Vision Satellite Entryway Foam Sanitizers

6-Zone PLC Vision Satellite Controller (120V)	# 976710
6-Zone PLC Vision Satellite Controller (24V)	# 976710-24V

Central Pump Systems (AODD)

Mini-Central Pump System (1/2" PP)	# 919050
Central Pump System (1" SS)	# 919060SS

High Flow Level Masters Provide an Automatic Supply of Ready-to-Use Chemical

60/10 High Flow Level Master	# 989106
60/20 High Flow Level Master	# 989108

Foam Solution Check Valves & Strainer

Check Valve, PP, 1/2" (EPDM)	# 491409
Check Valve, PP, 1/2" (Viton)	# 491411
Check Valve, 316SS, 1/2", MF (Teflon)	# 491348SS-T
Strainer, "Y", SS, 1/2" MF	# 150350-1

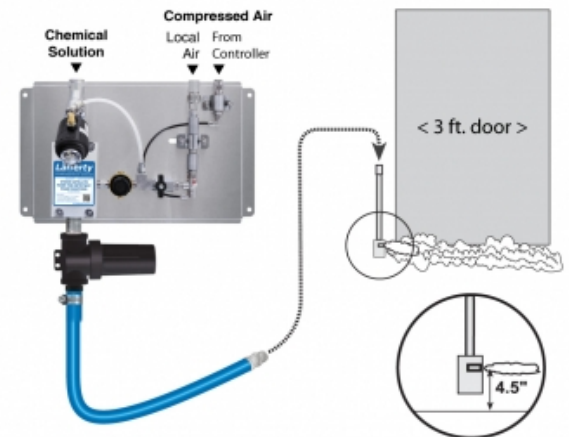

REQUIREMENTS

Ready-to-Use Chemical Solution

Temperature	up to 160°F
Pressure	35 to 75 PSI
Flow	1.34 GPM @ 40 PSI
Supply Line	1/2"

Compressed Air

up to 3 CFM

Hose

3/4" ID x 10'

Nozzle

Entryway Spreader

APPLICATIONS

- Agriculture/Horticulture
- Animal Health
- Dairy
- Food & Beverage
- Hatchery
- Pharm/Bio
- And Many Other Applications!

Lafferty
EQUIPMENT MANUFACTURING LLC
CFS TECHNOLOGIES

1.501.851.2820 | 1.800.999.2820
www.laffertyequipment.com

