

RADAR™ EP-LM Spray System

MODEL # 977890

OVERVIEW

The RADAR™ EP-LM Spray System is an electric eye activated, asphalt release applicator that mounts to a user-supplied drive-through arch for spraying asphalt truck beds. This system uses an electric pump to draw ready-to-use chemical solution from the included 7 Gallon Level Master™ tank which maintains a constant supply of solution. When a truck breaks the electric eye's line-of-sight, a delay timer allows the driver to position the truck under the spray nozzle before spraying begins and a run timer applies release agent for a pre-set time or until the vehicle leaves the spraying area, whichever is first.

Key Features

- Designed to spray asphalt release chemicals on to truck beds from a nozzle that attaches to an existing drive-through spray bar
- The electric pump draws ready-to-use chemical solution from the 7 Gallon Level Master™ which automatically maintains a constant supply of solution
- The system delays for an adjustable length of time when a truck breaks the beam of the electric eye, allowing the driver to position the truck, before activating for an adjustable, pre-set length of time
- The driver remains in his cab and avoids the risk of slip-and-fall injury and chemical waste
- Evenly coats the truck bed in just seconds, reducing run-off and chemical waste
- Spraying will stop if the driver leaves the area early
- The Level Master™ achieves a wide range of dilution ratios using city water pressure and precision metering tips
- Chemical resistant wetted components ensure years of outstanding performance with minimal maintenance
- Available with a magnetic sensor (#977895)
- See other Lafferty asphalt release equipment and industrial chemical applicators in [Catalog 8](#)

Includes

- Lockable, stainless steel pump enclosure
- 110V stainless steel electric pump
- Control box with delay/run timers and electric eye set
- 7 Gallon Level Master™ system
- 40' discharge hose with custom fan spray nozzle

OPTIONS

Heater Assembly

Retro-Fit Heater Assembly # 720981

Drum & Tote Stick Lengths & Seal Materials

Drum Stick, 33" (Viton or EPDM)	# 491643 / 491643-E
Drum Stick, 48" (Viton or EPDM)	# 491648 / 491648-E
Drum Stick, 54" (Viton or EPDM)	# 491645 / 491645-E
Tote Stick, 33" (Viton or EPDM)	# 491653 / 491653-E
Tote Stick, 48" (Viton or EPDM)	# 491654 / 491654-E
Tote Stick, 54" (Viton or EPDM)	# 491656 / 491656-E

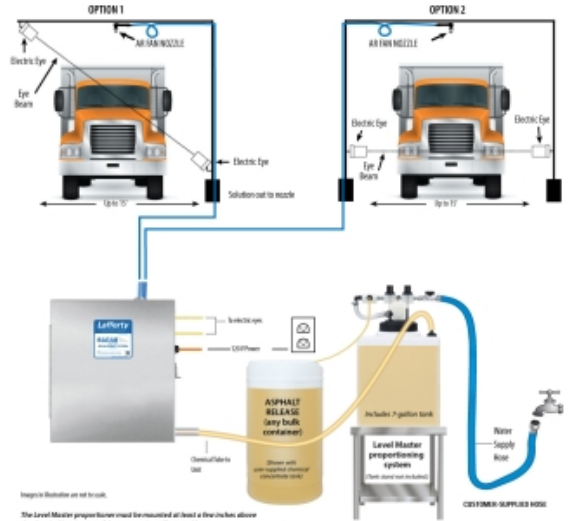

RADAR™ RAPID DRIVE THRU ASPHALT RELEASE

REQUIREMENTS

Chemical Concentrate

Water

Temperature	up to 160°F
Pressure	35 to 125 PSI
Supply Line	1/2"

Hose

3/4" ID x 40'

Nozzle

#180193SS

Electric

120V / 20A

See Separate Instructions for:

Level Master™ 989304



Asphalt Release Spray Nozzle Assembly
Provides a coarse, wide fan spray pattern for quick, complete coverage.